

# University of Western Ontario - Student Services Centre

As the project's aboriginal consultant, Two Row Architect believed that cultural planning principles, values and motifs should pay homage to local Indigenous people and respect others on a North America wide basis. It was desired that elements be expressed in the building such as wood and stone with a particular emphasis on water. Further notions that the four directions and their associated colours make reference to all peoples and extend worldwide is worth pursuing in the architecture. With Western's preference for the collegiate gothic style, opportunities were sought for the windows and fenestration to make reference to historic precedents such as wampum belts, clan symbols, etc. The landscaping was designed to reinstate indigenous species and while providing further opportunities for interpretation through an educational component and suggested harvesting as well.

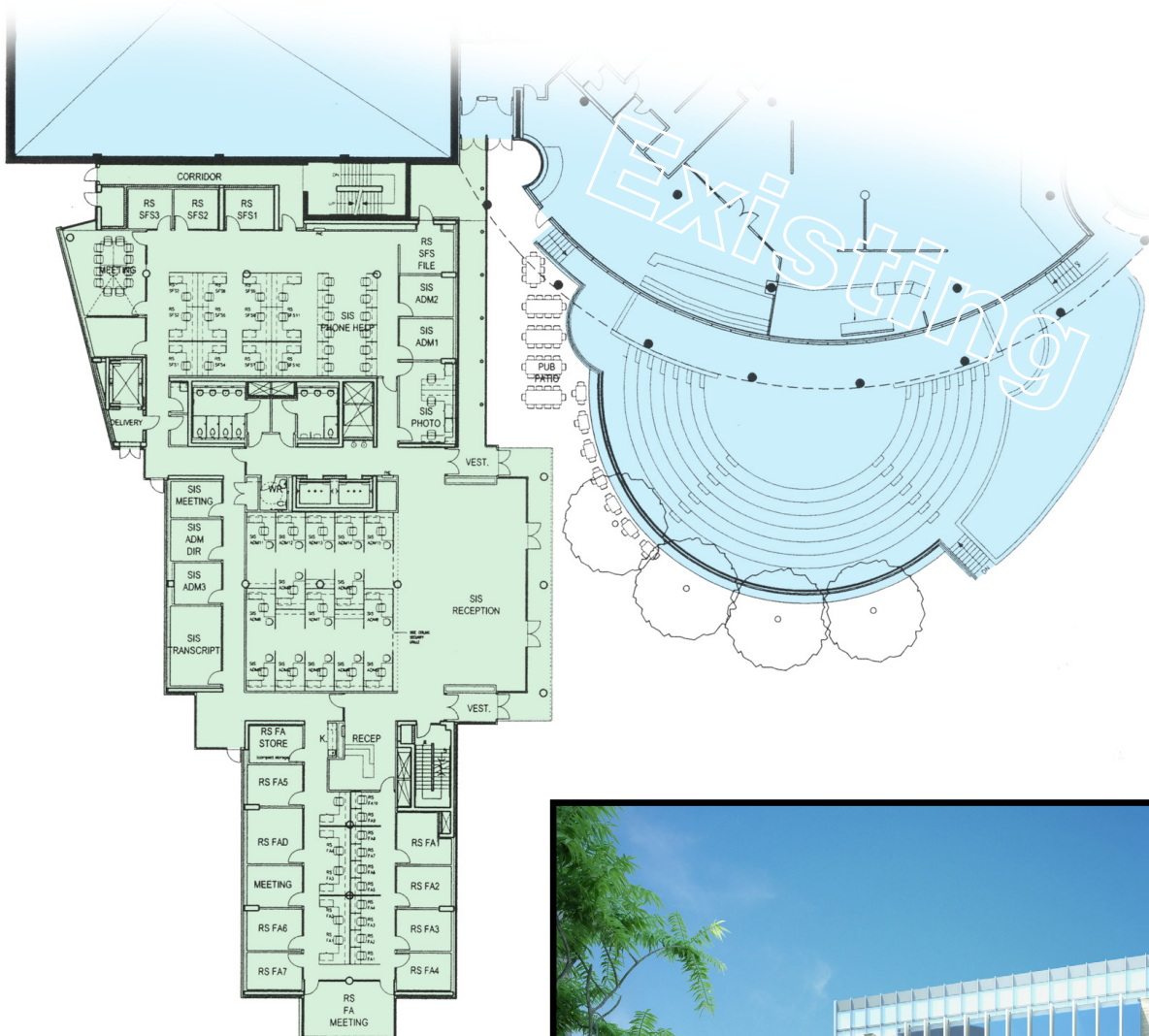

Client: University of Western Ontario  
Size: 54,000 ft<sup>2</sup>  
Cost: 21 Million  
Architect: Diamond & Schmitt  
Completion: 2009

Two Row Architect