

Seneca Nation of Indians - Allegany Administration Building

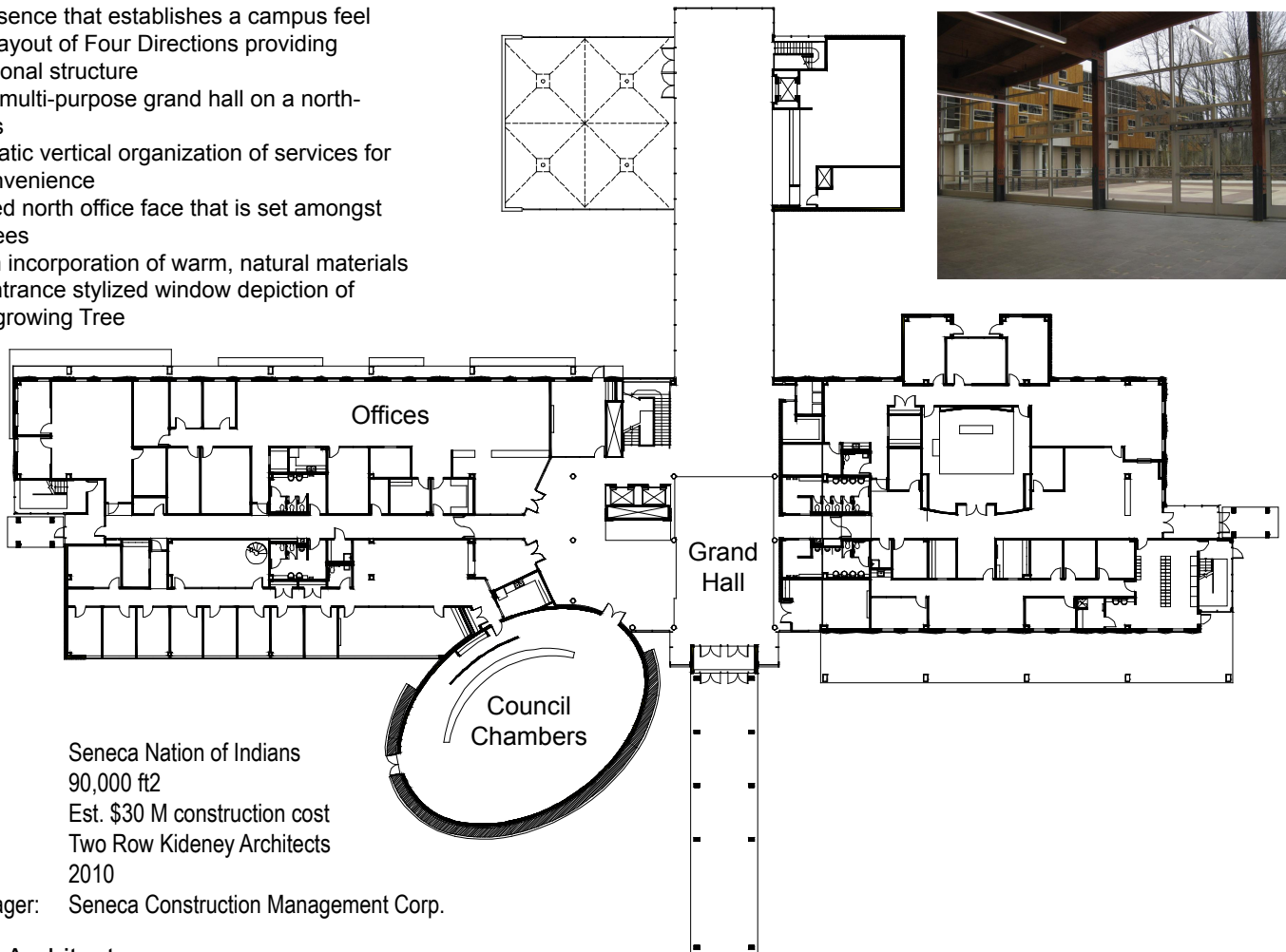

This facility was designed by way of Seneca Nation participation through workshops involving all personnel with individual community members as well. With a proud heritage and history, the goal was to reinterpret Seneca Culture in a modern, authentic and respectful manner. The outcome of this shared vision presents the following features:

- A Council Chamber incorporating the 13 phases of the moon
- A landscaped terrace and green roof
- Maximum incorporation of indigenous species
- An outdoor gathering circle paying homage to Veterans
- A site presence that establishes a campus feel
- A facility layout of Four Directions providing organizational structure
- A scenic, multi-purpose grand hall on a north-south axis
- A democratic vertical organization of services for public convenience
- An inspired north office face that is set amongst mature trees
- Maximum incorporation of warm, natural materials
- A main entrance stylized window depiction of The Evergrowing Tree



Client: Seneca Nation of Indians
 Size: 90,000 ft²
 Cost: Est. \$30 M construction cost
 Architect: Two Row Kidney Architects
 Completion: 2010
 Const. Manager: Seneca Construction Management Corp.

Two Row Architect